

**For automotive or industrial applications with a Ø12 mm shaft.**

- Compact seal
- Simple concept (optimized forms)
- Ease of Assembly on pump (impeller independence)
- Metallic sleeve “Press to fit” assembly
- Compatible in Ethylene Glycol coolant
- **Temperature:** -40 °C to 150 °C
- **Pressure:** up to 5 bar
- **Speed:** up to 12 000 rpm
- **Air test :** 1,5 cc/min at 1,2 bar
- **Water leakage:** 15 g/500h



Data above are minimum performance values for standard conditions of use

SEAL COMPONENTS	MATERIALS
Primary Ring	Hard carbon/Carbographite
Mating Ring	Porous Silicon Carbide
Retainer	Stainless Steel
Bellows	HNBR
Spring	Stainless Steel
Ferrules	Stainless Steel
Cup	HNBR
Sleeve	Stainless Steel

Direction / Contact

## Operating Limits

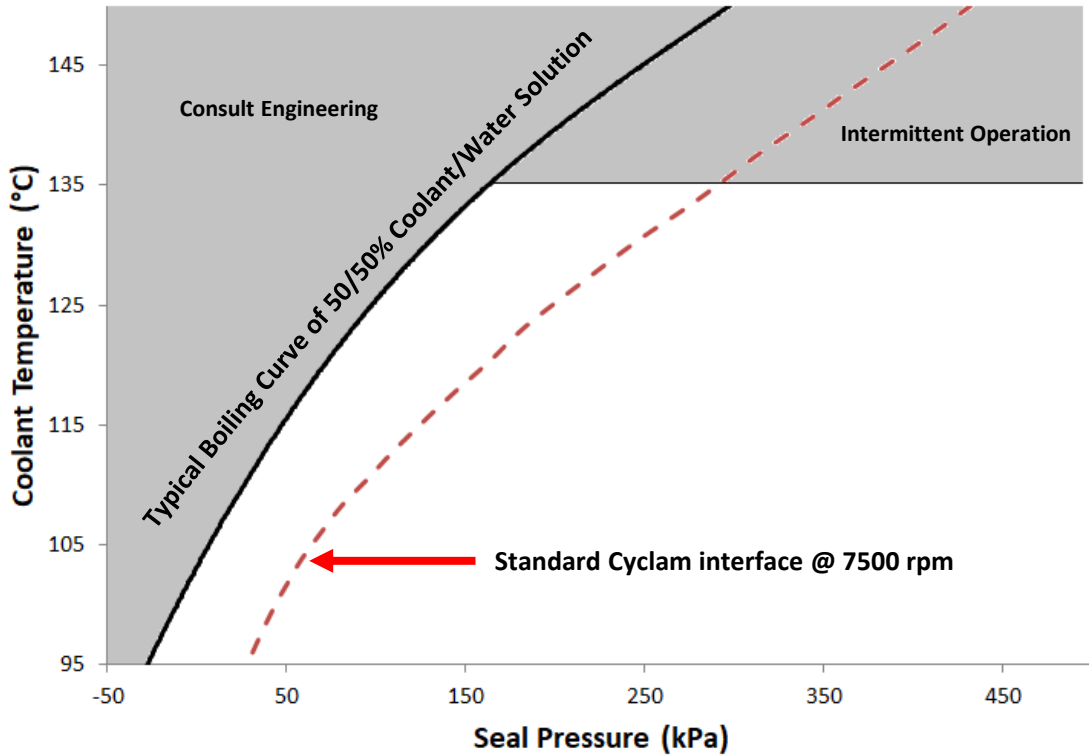

## Dimensional Data

**Shaft (D1)**

12 mm

**Bore Diameter (D2)**

30,00 mm

**Working Length (L3)**

7,15 mm

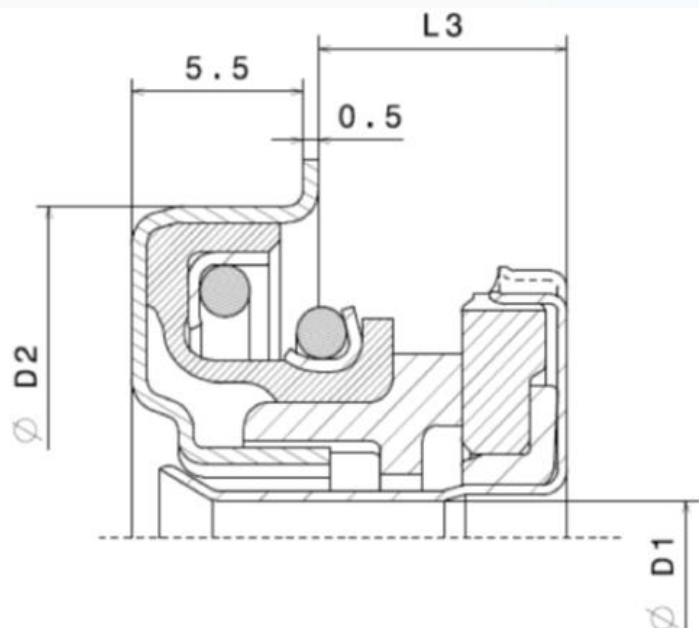

Direction / Contact