

**For automotive or industrial applications with a Ø12 mm shaft.**

- Compact seal
  - Simple concept (optimized forms)
  - Ease of Assembly on pump (impeller independence)
  - Metallic sleeve “Press to fit” assembly
  - Compatible in Ethylene Glycol coolant
  - Noise reduction with wave spring
  
  - **Temperature:** -40 °C to 150 °C
  - **Pressure:** up to 5 bar
  - **Speed:** up to 12 000 rpm
  - **Air test :** 1,5 cc/min at 1,2 bar
  - **Water leakage:** 15 g/3000
- Data above are minimum performance values for standard conditions of use



SEAL COMPONENTS	MATERIALS
Primary Ring	Hard carbon/Carbographite
Mating Ring	Porous Silicon Carbide
Retainer	Stainless Steel
Bellows	HNBR
Spring	Stainless Steel
Ferrules	Stainless Steel
Cup	HNBR
Sleeve	Stainless Steel

Direction / Contact

## Operating Limits

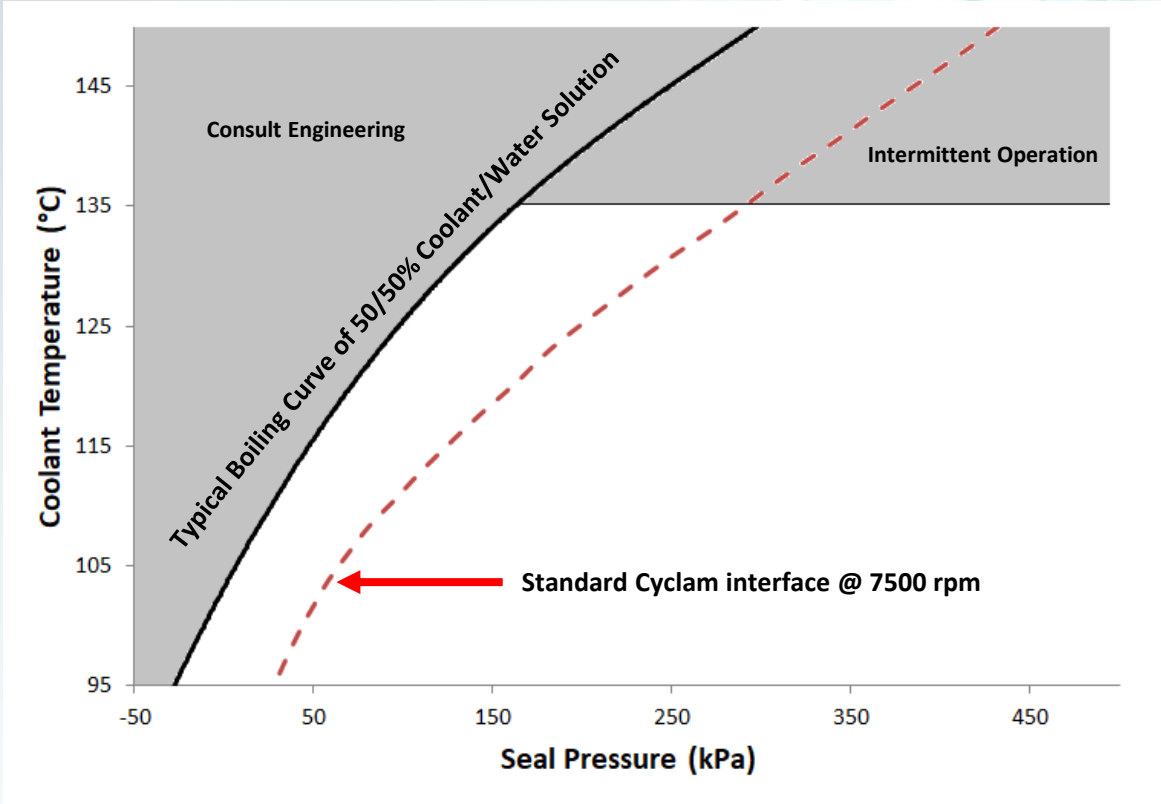

## Dimensional Data

<b>Shaft (D1)</b>
12 mm
<b>Bore Diameter (D2)</b>
30,00 mm
<b>Working Length (L3)</b>
7,15 mm

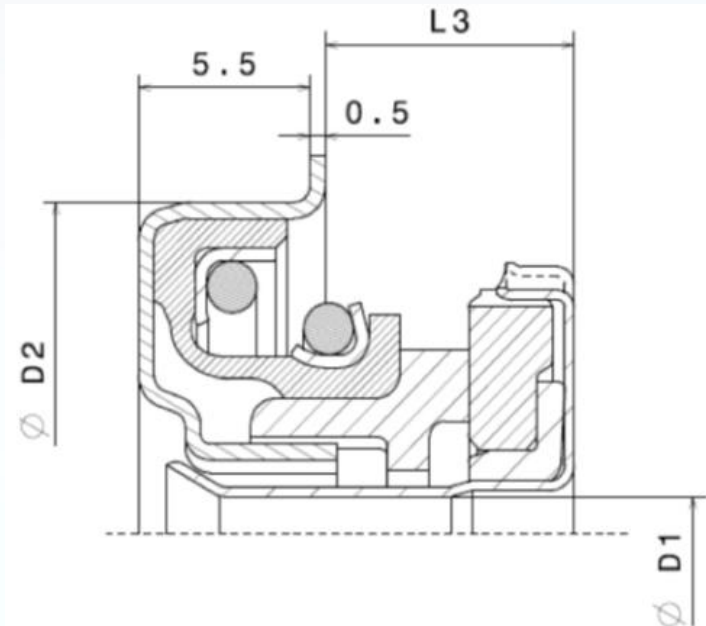

Direction / Contact